

REPORT OF LOAD TESTS ON CABLEDUCT 700+ SERIES FLOORBOX

Summary No. 0322

Test Reference: SW033.07

Issue Date: 04/04/2007

Project

On behalf of the client, Cableduct Ltd, CERAM Building Technology were requested to undertake a point load test on an installed 700+ Series floorbox.

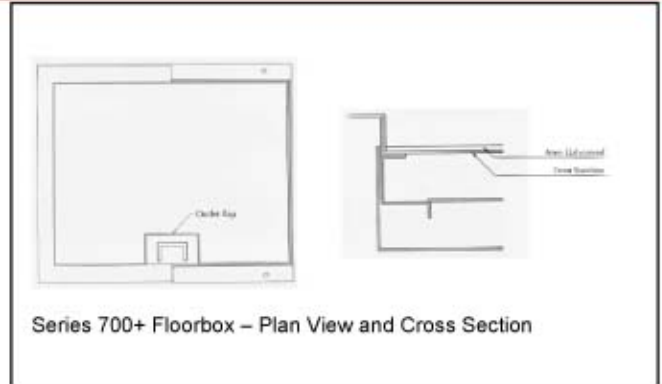

Series 700+ Floorbox – Plan View and Cross Section

Client



Cableduct Ltd.
30 Selhurst Rd
London
SE25 5QF

Test Method

25x25mm Square point loading in the centre of an installed 700+ Series floorbox based on the test method T8.00 in PSA MOB PF2 PS/SPU "Performance Specification for Platform Floors". Deflection measurements were taken at every 1.5kN, as load was applied, up-to a maximum load of 3.0kN. This load was then held for 24 hours. The load was then increased until failure of the floorbox occurred. The tests were carried out in accordance with the requirements for a medium grade system, which are:-

- maximum deflection after 24 hours at 1.5kN \leq 2.40mm
- stability between 23 and 24 hours \leq 0.02mm
- permanent deformation \leq 0.50mm
- sustain 3 x safety factor load (9kN) for not less than 5 minutes

Test Results

Results from the 25mm square loading test

Load Applied (kN)	Deflection as Load Applied (mm)
0.0	~
1.5	1.05
3.0	2.02
24 hours loading @ 3kN	2.11
Permanent Deflection	0.01

Failure occurred at 19.96kN.

Note:

As the floorbox was tested within a panel, the panel deflection was monitored and has been removed as appropriate.

Assessment

The 700+ Series floorbox withstood the load of 3.0kN (medium grade) with a deflection of 2.02mm. After the load had been held for 24 hours the deflection had crept to 2.11mm, an increase of 0.09mm. Upon removal of the load the permanent deflection was recorded as 0.01mm. The 700+ Series floorbox maintained a safety factor load of 9kN without failure and failed at a load of 19.96kN. The 700+ Series floorbox passes the requirements for a medium grade system in accordance with the requirements stated in PSA MOB PF2 PS/SPU

Authorised by:

Dave Dix
(Project Manager, Structures Group)

This report is issued in accordance with the conditions of Business of CERAM Research and relates only to the sample(s) tested. No responsibility is taken for the accuracy of the sampling unless this is done under our own supervision. This report shall not be reproduced in part without the written approval of CERAM Research, nor used in any way as to lead to misrepresentation of the results or their implications.